

How to Hang & Stilt Flat Ornaments on a Rod without Bending the Rod

If you have a 10" rod, keep ornaments to either side or you can add another post in the center for extra safety.

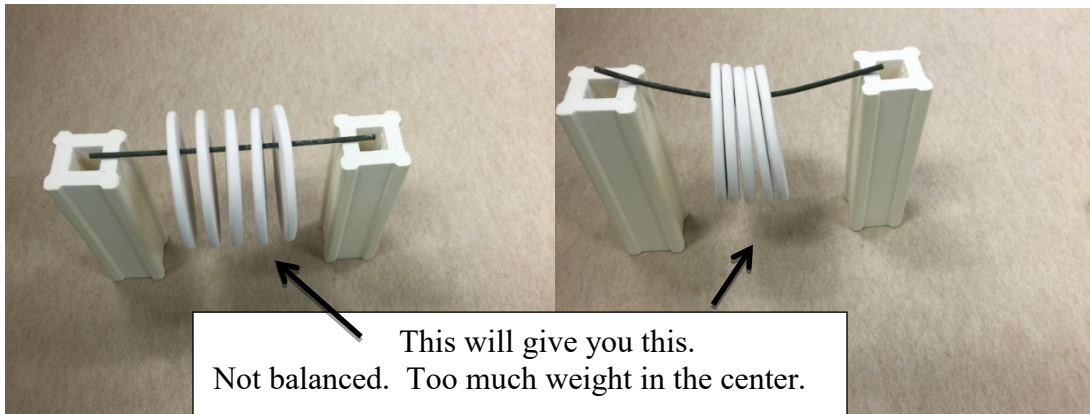
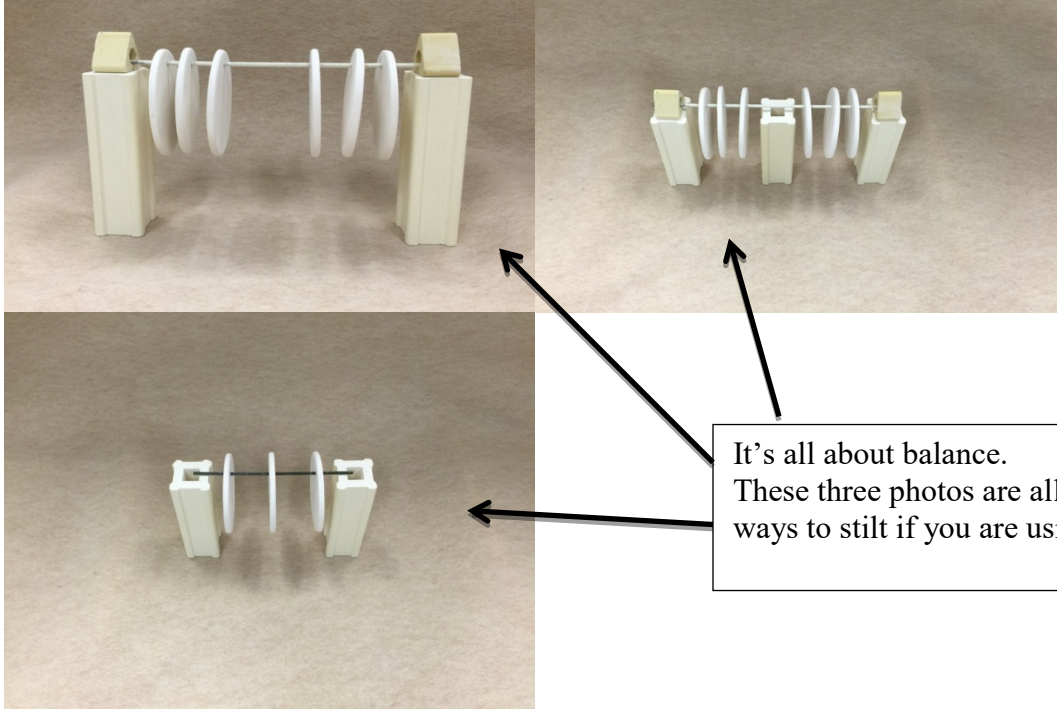

It's best to kiln wash the rods and also clean out the hole of the ornament after it's dipped in clear glaze to help keep the glaze from melting to the rod. If you take these precautions, you will reduce the chances of the rods bending.

gare[®]

phone 888-289-4273

questions@gare.com

gare.com